

1900~1970nm 3-port Optical Circulator for Pulse Power

FEATURES

- High Isolation
- Low Insertion Loss
- Epoxy-Free Optical Path
- High Reliability and Stability
- Low Profile Packaging

APPLICATIONS

- Fiber Optic Amplifiers
- Fiber Optic Instruments
- WDM Systems
- Dispersion Compensation
- Light Routing

SPECIFICATIONS

Parameter	Unit	Value	
Center Wavelength (λ_c)	nm	1900	1930, 1950, 1970
Bandwidth	nm	+/-10	+/-20
Insertion Loss@23°C	(Typ.)	dB	1.5
	(Max.)	dB	1.9
Isolation@23°C	(Typ.)	dB	16
	(Min.)	dB	14
PDL	dB	≤0.2	
Optical Return Loss	dB	≥45	
Cross Talk	dB	≥40	
Fiber Type	-	SMF-28 Fiber or SM1950 Fiber (V) 10/130um DC Fiber (O) or 25/250um DC Fiber (R)	
Fiber Tensile Load	N	5	
Max. Average Optical Power	W	0.3, 0.5, 1, 2, 3, 5, 10, 15, 20	
Max. Peak Power for Pulse	kW	0.1, 1, 2, 3, 5, 10, 15, 20	
Operating Temperature	°C	0~50	
Storage Temperature	°C	-40~85	

- Note:**
- Specifications are for device without connectors; Specifications may change without notice.
 - To add connectors, IL is 0.3dB higher, RL is 5dB lower.
 - Only guarantee 1W continuous wave (CW) power thru testing for connectors added.
 - Devices for higher optical power or with other type fiber or consigned fiber are also available; Devices can only work in the core of Double Cladding (DC) Fiber, Cladding Power must be stripped before connecting the device.
 - Package size may be different for different optical power and fiber types.

PACKAGE DIMENSION

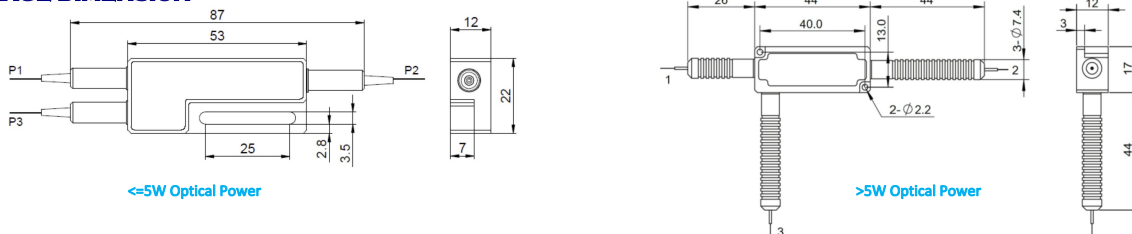

ORDERING INFORMATION (PN)

FCIR-	NNNN	-3H NN	P NN	- (NN)	- (C)	C	NN	- CC/CCC
	<i>Center Wavelength</i>	<i>Average Power</i>	<i>Peak Power</i>	<i>Average Power P2</i>	<i>Fiber Type</i>	<i>Fiber Sleeve</i>	<i>Fiber Length</i>	<i>Connector Type</i>
	1900~ 1900nm	03=300mW	01=100W	1= 1W	V=SM1950 Fiber	B= Bare fiber	05=0.5m	N=Without Connector
	1930~ 1930nm	1= 1W	1= 1kW	2= 2W	O=10/130 DC Fiber	L= Loose Tube	10=1.0m	FC/APC=FC/APC Connector
	1950~ 1950nm	5= 5W	5= 5kW	5=5W	R=25/250 DC Fiber	2= 2mm Cable	15=1.5m	LC/PC=LC/PC Connector
	1970~ 1970nm	10=10W	10=10kW	Blank for P2=P1	Blank for SMF-28 Fiber	3= 3mm Cable	20=2.0m	SC/UPC=SC/UPC Connector