

1030nm High Power Free Space Isolator

FEATURES

- High Isolation
- Low Insertion Loss
- Epoxy-Free Optical Path
- High Reliability and Stability
- Low Profile Packaging

APPLICATIONS

- Fiber Optic Amplifiers
- Fiber Optic Instruments
- WDM Systems
- Transmitters and Fiber Lasers
- CATV Networks

SPECIFICATIONS

Parameter	Unit	High Power Type
Center Wavelength (λ_c)	nm	1030
Operating Wavelength Range	nm	+/-10
Peak Isolation (Typ.)	dB	26~30
Min. Isolation (23°C)	dB	20
Typical Insertion Loss (λ_c , 23°C)	dB	0.5
Max. Insertion Loss (λ_c , 23°C)	dB	0.7
Clear Aperture	mm	2.0
Input Polarization Plane	-	As indicated
Maximum Optical Power	W	1, 3, 5, 10, 20
Operating Temperature	°C	0~50
Storage Temperature	°C	-20~75

Note: 1. Devices for higher optical power and pulse power are also available.

PACKAGE DIMENSION

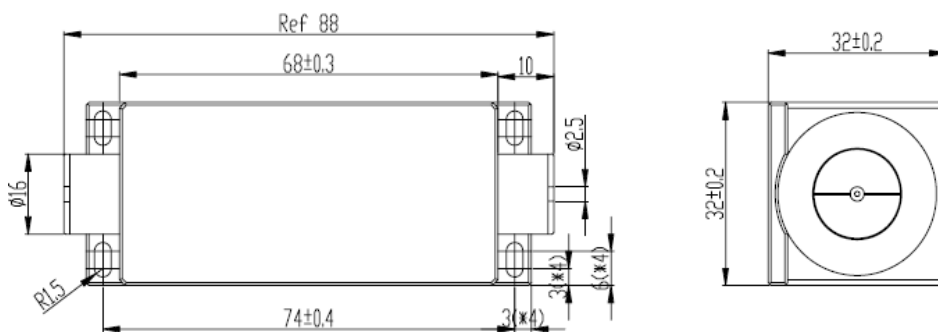

ORDERING INFORMATION (PN)

FISF-	NNNN	-HP	NN	-	NN
	<i>Center Wavelength</i>		<i>Optical Power</i>		<i>Clear Aperture</i>
	1030-1030nm		3-3W		20=2.0mm
			10-10W		
			20-20W		