

1030nm 3-port PM Optical Circulator

FEATURES

- ▣ High Isolation
- ▣ Low Insertion Loss
- ▣ Epoxy-Free Optical Path
- ▣ High Reliability and Stability
- ▣ Low Profile Packaging

APPLICATIONS

- ▣ Fiber Optic Amplifiers
- ▣ Fiber Optic Instruments
- ▣ WDM Systems
- ▣ Dispersion Compensation
- ▣ Light Routing



SPECIFICATIONS

Parameter		Unit	A Type	B Type	C Type
Center Wavelength		nm	1030		
Bandwidth		nm	+/-5		
Insertion Loss (1→2, 2→3)	(Typ.)	dB	5.6	2.9	
	(Max.)	dB	7.8	4.0	
Isolation@ 23°C (3→2, 2→1)	(Typ.)	dB	35	23	
	(Min.)	dB	30	18	
Cross Talk		dB	≥50		
Optical Return Loss		dB	≥50		
Extinction Ratio	(Typ.)	dB	25	22	20
	(Min.)	dB	22	20	18
Work Mode	S Type	-	Can only work in Slow Axis		
	F Type	-	-	Both Axis Working	
Fiber Type		-	PM980 Fiber, PM1060L Fiber (E) or PM1060L-FA Fiber (L)		
		-	10/125um PMDC Fiber (O) or 15/130um PMDC Fiber (W)		
		-	20/130um PMDC Fiber (Q) or 25/250um PMDC Fiber (R)		
Fiber Tensile Load		N	5		
Maximum Optical Power (CW)		mW	50		
Operating Temperature		°C	0~50		
Storage Temperature		°C	-40~85		-20~75
Package Dimension	Stainless Steel Tube (SST)	mm	∅5.5x35		See Drawing
	Metal Box	mm	L120x ^W 12x ^H 10		

- Note:**
- Specifications are for device without connectors; Specifications may change without notice.
 - To add connectors, IL is 0.5dB higher, RL is 5dB lower, ER is 2dB Lower, Connector key is aligned to slow axis.
 - Devices for higher optical power or with other type fiber or consigned fiber are also available; Devices can only work in the core of Double Cladding (DC) Fiber, Cladding Power must be stripped before connecting the device.

PACKAGE DIMENSION (C TYPE)

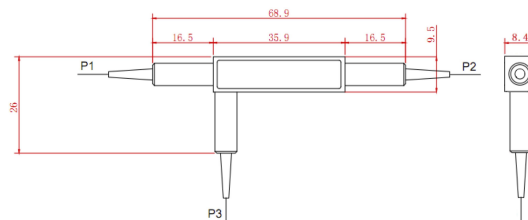

ORDERING INFORMATION (PN)

FPCR-NNNN	-	(C)	3	C	-	(C)	C	C	NN	-	CC/CCC
<i>Center Wavelength</i>		<i>Work Mode</i>		<i>Type</i>		<i>Package</i>	<i>Fiber Type</i>	<i>Fiber Sleeve</i>	<i>Fiber Length</i>		<i>Connector Type</i>
1030-1030nm		F=F Type Blank for S Type		A=A Type B=B Type C=C Type		M=Metal Box Blank for SST or C Type	2=PM980Fiber E=PM1060L Fiber Q=20/130 PMDC Fiber R=25/250 PMDC Fiber	B= Bare Fiber L= Loose Tube 2= 2mm Cable 3= 3mm Cable	05=0.5m 10=1.0m 15=1.5m 20=2.0m		N=Without Connector FC/APC=FC/APC Connector LC/PC=LC/PC Connector SC/UPC=SC/UPC Connector

