

900~950nm High Power Tap Isolator Hybrid for Pulse Power

FEATURES

- Low Excess Loss
- High Stability and Reliability
- Epoxy Free Optical Path

APPLICATIONS

- Optical Amplifier
- Optical Networks
- Power Monitoring

SPECIFICATIONS

Parameter	Unit	Value
Center Wavelength	nm	915, 930, 940, 950
Bandwidth	nm	+/-10
Split Ratio	-	0.1:99.9, 1:99, 2:98, 5:95, 10:90, 20:80, 30:70, 40:60, 50:50
Tap Ratio	-	0.1%, 1+/-0.6%, 2+/-0.8%, 5+/-1.0%, 10%, 20%, 30%, 40%, 50%
Excess Loss Max.	dB	1.8
Min. Isolation (23°C)	dB	20
PDL	dB	≤0.2
Working Mode	-	Tap Input Light before Isolator
Optical Return Loss	dB	≥45
Fiber Type	Tap Port	Same fiber or 105/125um MM Fiber
	Thru Port	HI780 Fiber, HI1060 Fiber or 10/125um SC Fiber (E)
		10/125um DC Fiber (O), 15/130um DC Fiber (W) 20/130um DC Fiber (Q) or 25/250um DC Fiber (R)
Fiber Tensile Load	N	5
Max. Average Optical Power	W	0.5, 1, 2, 3, 5, 10, 15, 20, 30
Max. Peak Power for pulse	kW	0.1, 1, 2, 3, 5, 10, 15, 20
Operating Temperature	°C	0~50
Storage Temperature	°C	-40~85

- Note:**
1. Specifications are for device without connectors; Specifications may change without notice.
 2. To add connectors, IL is 0.7dB higher, RL is 5dB lower.
 3. Only guarantee 1W continuous wave (CW) power thru testing for connectors added.
 4. Devices for higher optical power or with other type fiber or consigned fiber are also available; Devices can only work in the core of Double Cladding (DC) Fiber, Cladding Power must be stripped before connecting the device.

PACKAGE DIMENSION

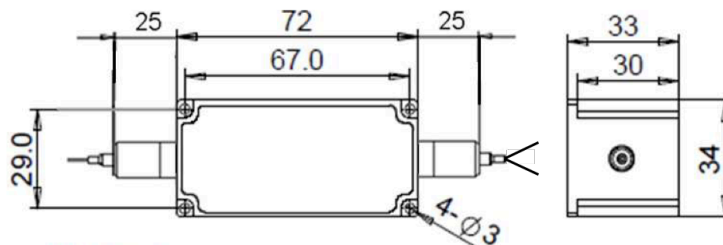

ORDERING INFORMATION (PN)

Wavelength	Split Ratio	Tap Port Fiber	Average Power	Peak Power	Fiber Type	Fiber Sleeve	Fiber Length	Connector Type
915-915nm	01-1/99	A=105/125um Fiber	05-500mW	01-100W	H=HI1060 Fiber	B= Bare Fiber	05=0.5m	N=Without Connector
930-930nm	10-10/90	Blank for Same Fiber	5=5W	1=1kW	E=10/125 SC Fiber	L= Loose Tube	10=1.0m	FC/APC=FC/APC Connector
940-940nm	30-30/70		10=10W	5=5kW	R=25/250 DC Fiber	2= 2mm Cable	15=1.5m	LC/PC=LC/PC Connector
950-950nm	50-50/50		20=20W	10=10kW	Blank for HI780 Fiber	3= 3mm Cable	20=2.0m	SC/UPC=SC/UPC Connector